

# Here's what you need to know about Lexis Advance<sup>®</sup> pricing

Lexis Advance<sup>®</sup> offers **straightforward pricing that you can understand fully**—and act on without being concerned about mistakes.

That's important if:

**You're a new associate**, because you want to do your best work and show you're a good hire, without worrying that you might be incurring research charges without even knowing it.

**You're a legal research & writing instructor**, because you don't have the time or resources to stay up to date on every vendor's pricing. But you want your students to be effective researchers and "practice ready."

1

## No search charges or hourly charges ... no meter is running

Search across sources. Open any subscription document. Subscriptions also include these features at no additional charge:

- **Filtering search results**
- **Shepard's<sup>®</sup> reports** and viewing in-plan citing references
- **All document delivery** options, e.g., print
- **All alert** set-up, delivery and review of in-plan documents

+

## Research documents are recorded for cost recovery only

All documents accessed in a law firm setting are recorded for the LexisNexis<sup>®</sup> invoice to help an organization prorate their monthly subscription fee, if desired.

2

## No accidental charges

What about non-subscription documents in your search results? To incur added charges, you must take active steps to open the out-of-plan documents:

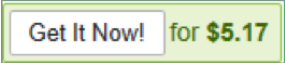
- All **out-of-plan documents are clearly labeled** on the results screen
- 
- Not sure you want to purchase? **Save an out-of-plan document** without opening it—again, no charge
  - If you opt to purchase an out-of-plan document, the Get It Now charge covers:
    - **Accessed (\$)** - available until Jan 27, 2015 **All access for 90 days**, plus access to original source PDFs with the document
    - **Accessed (\$)** - available until Oct 30, 2015 **All Folder access for one year**, that is, you save the document to a **Folder** and access that document from the **Folder**
    - **All Shepard's reports for that document** as well as all delivery, e.g., email, for the document

# Lexis Advance® Pricing

It's straightforward and simple. There are no search charges ... no hourly charges ... no meter running. If the document you need is in your subscription, use it, save it, send it and analyze it. It's covered. You can even search out-of-plan sources and incur no cost until you open a relevant document. Here's a Lexis Advance subscription pricing overview:

## NO EXTRA CHARGE

(Part of your Lexis Advance subscription ... unlimited use, every day)

### Search Subscription Sources

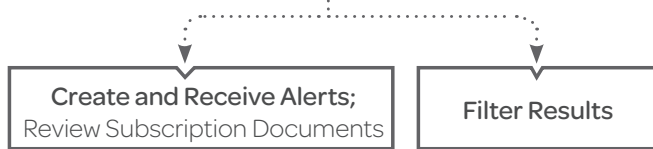

Subscription Document

### Search Out-of-Plan Sources

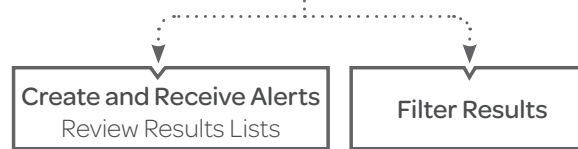

Out-of-Plan Document

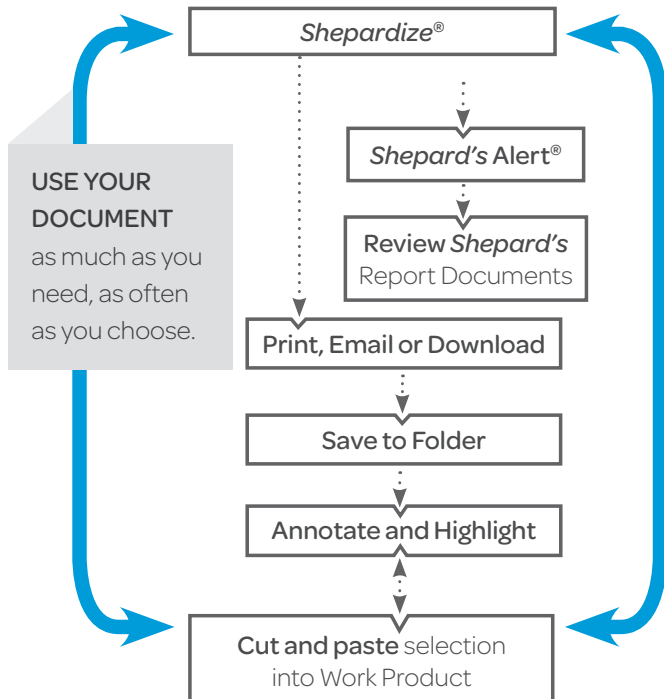

**USE YOUR DOCUMENT**  
as much as you need, as often as you choose.

### ONCE OPENED

Use an out-of-plan document for **90 days with no additional charge**—one year if you save it to a Folder. In other words, use it like a subscription document during that time.

## ONE-TIME DOCUMENT CHARGE

(Not included in your Lexis Advance subscription)

Click **GET IT NOW** to open or deliver (e.g., print, download, email) out-of-plan document

Open **full-text, out-of-plan document** (after clicking Get it Now):

- From a results list
- Enter a cite to a full-text, out-of-plan document
- From an alerts results list
- Link from a full-text document

